

# Development Referral Notice



File Number: DP2023-02

Date: March 21, 2023

Owner/Applicant: GP Networks

## Application Details

Please be advised that our office has received the following proposed fiber optic alignment within the Town of Beaverlodge.

## Comments

Should you have any concerns or comments regarding this development, please advise by responding to this email [development@beaverlodge.ca](mailto:development@beaverlodge.ca) within 14 days of this notice.

Comments received are deemed public information.

## Distribution List

### E-Mail:

Administrator: Jeff Johnston

Public Works Manager: Nick Kebalo

Nick Lapp, County of Grande Prairie #1

Peace Wapiti School Division # 76

Grande Prairie 7 District Catholic School District #28

Alberta Transportation

Eastlink

Area Councillor: Judy Kokotilo-Bekkerus

Alberta Health Services

ATCO Pipeline Gas

ATCO Electric

### Attachments:

Development Permit Application

Proposed Alignment



# DEVELOPMENT PERMIT APPLICATION FORM A

FOR ADMINISTRATIVE USE

APPLICATION NO.	DP2023-02
DATE RECEIVED	March 21, 2023

Town of Beaverlodge, 400-10<sup>th</sup> Street, Box 30, Beaverlodge, AB, T0H 0C0  
 W: [beaverlodge.ca](http://beaverlodge.ca) | E: [development@beaverlodge.ca](mailto:development@beaverlodge.ca) | T: (780) 354-2201 | F: (877)309-9281

I / We hereby make application under the provisions of the Land Use Bylaw for a Development Permit in accordance with the plans and supporting information submitted herewith and form part of this application. I / We understand that this application will not be accepted without the following:

- (a) application fee;
- (b) site plan sketch that includes all relevant detail to the proposed development (e.g.: proposed and existing structures, property lines, creeks/ravines, parking and vehicle access, building plans, etc.)

APPLICANT INFORMATION			COMPLETE IF DIFFERENT FROM APPLICANT		
NAME OF APPLICANT GPNetworks (G.P.N. Wireless Networks Solutions Ltd)			NAME OF REGISTERED OWNER		
ADDRESS 105- 9715 105 St.			ADDRESS		
Grande Prairie, AB					
POSTAL CODE T8V 7X7			POSTAL CODE		
EMAIL ADDRESS* projects@gpnetworks.ca			EMAIL ADDRESS*		
*By supplying the Town with an email address, you agree to receive correspondence by email.					
PHONE (CELL) 780-296-4987 (Boris)	PHONE (RES)	PHONE (BUS) 780-882-6623	PHONE (CELL)	PHONE (RES)	PHONE (BUS)

LAND INFORMATION			
Address of proposed development site: <u>Starting at TWP RD 720 (3rd St. W), east side of 1st Ave, running to Beaverlodge Campground and running east into 10th Street and 10A Street.</u>			
Legal description of proposed development site: REGISTERED PLAN: _____ BLOCK: _____ LOT (parcel): _____			
Other legal description: _____			
Description of the existing use of the land: _____			
Proposed Development: <u>Fiber optic internet deployment</u>			
Does the Development Permit require an amendment to the Land Use Bylaw? Yes _____ No _____			
If yes, has an amendment to the Land Use Bylaw been submitted? Yes _____ No _____			
Estimated:	Date of Commencement: _____  March 27, 2023	Date of Completion: _____  May 31, 2023	Value of Construction: \$ _____  +/- \$600,000.00

**FOR NEW CONSTRUCTION ONLY**

LOT AREA: \_\_\_\_\_ LOT WIDTH: \_\_\_\_\_ LOT LENGTH: \_\_\_\_\_ PERCENTAGE OF LOT OCCUPIED: \_\_\_\_%

LOT TYPE:  INTERIOR  CORNER  WITH LANE  WITHOUT LANE

PRINCIPLE BUILDING YARDS: FRONT: \_\_\_\_\_ REAR: \_\_\_\_\_ SIDE (1): \_\_\_\_\_ SIDE (2): \_\_\_\_\_

BUILDING HEIGHT ABOVE FINISHED GRADE: \_\_\_\_\_ NUMBER OF PARKING STALLS: \_\_\_\_\_

ACCESSORY BUILDING YARDS: FRONT: \_\_\_\_\_ REAR: \_\_\_\_\_ SIDE (1): \_\_\_\_\_ SIDE (2): \_\_\_\_\_

SPECIAL CHARACTERISTICS OF LAND (agricultural, swampy, bush): \_\_\_\_\_

PROVISIONS FOR WATER SERVICE: Municipal  Private Well

PROVISIONS FOR SANITARY SEWER: Municipal  Onsite System

(Note if you are connecting to Municipal services you will need to complete our Service Connection Application)

USE OF ADJACENT PROPERTIES: \_\_\_\_\_

ON AN ATTACHED SHEET, PLEASE PROVIDE A SCALED PLAN INDICATING THE LOCATION AND DIMENSIONS OF EXISTING AND PROPOSED IMPROVEMENTS, INCLUDING:

- Property lines surround the site
- Parking, roads, sidewalks
- Above ground utilities and direction of storm water drainage off the site
- Building and structures
- Landscaping, fences and screening

**FOR NEW SIGNAGE**

Free Standing/Pylon Sign

Temporary Sign

Fascia/Wall Sign

Permanent Sign

Billboard Sign

Dimensions of Sign: Horizontal: \_\_\_\_\_ Vertical: \_\_\_\_\_ Depth: \_\_\_\_\_

Canopy or Awning Sign

Height from ground to highest point of sign: \_\_\_\_\_

**DECLARATION**

I/WE HEREBY AUTHORIZE REPRESENTATIVES OF THE TOWN TO ENTER MY/OUR LAND FOR THE PURPOSE OF CONDUCTING A SITE INSPECTION IN CONNECTION WITH THIS APPLICATION

I/WE HEREBY DECLARE THAT THE ABOVE INFORMATION IS, TO THE BEST OF MY/OUR KNOWLEDGE, FACTUAL AND CORRECT

March 21, 2023

DATE

SIGNATURE OF APPLICANT

NOTE:

Signature of Registered

Landowner required if different

LANDOWNER/LEASEHOLDER

From Applicant

DATE

SIGNATURE OF REGISTERED

The personal information on this form is collected under the authority of Section 33 (c) of the Freedom of Information and Protection of Privacy Act, Section 642 of the Municipal Government Act and or the Safety Code Act. The information will be used to process your application(s) and your name and or address of where the development is being proposed may be made available to the public upon request or at a public meeting. If you have questions on the collection and use of this information, please contact the Town Office.

# GPNETWORKS FIBER PLACEMENT TOWN OF BEAVERLODGE AREA COUNTY OF GRANDE PRAIRIE No.1

## DRAWING LIST

### DRAWING NO.

### DESCRIPTION

TWN\_OF\_BVRLDGE\_CNTY\_OF\_GP\_No1\_COVER

COVER

TWN\_OF\_BVRLDGE\_CNTY\_OF\_GP\_No1\_KEY 201

LOCATION KEYPLAN

TWN\_OF\_BVRLDGE\_CNTY\_OF\_GP\_No1\_NOTES

CONSTRUCTION NOTES

TWN\_OF\_BVRLDGE\_CNTY\_OF\_GP\_No1\_TYP01 TO 02

TYPICAL DETAILS

TWN\_OF\_BVRLDGE\_CNTY\_OF\_GP\_No1\_LEGEND

LEGEND

TWN\_OF\_BVRLDGE\_CNTY\_OF\_GP\_No1\_2001 TO 2007

CONSTRUCTION DRAWINGS

TWN\_OF\_BVRLDGE\_CNTY\_OF\_GP\_No1\_TC01

TRAFFIC CONTROL

The logo for GPNetworks, with 'GP' in blue and 'Networks' in green. The 'o' in 'Networks' is stylized with a grid of dots.

# GPNETWORKS FIBER PLACEMENT TOWN OF BEAVERLODGE

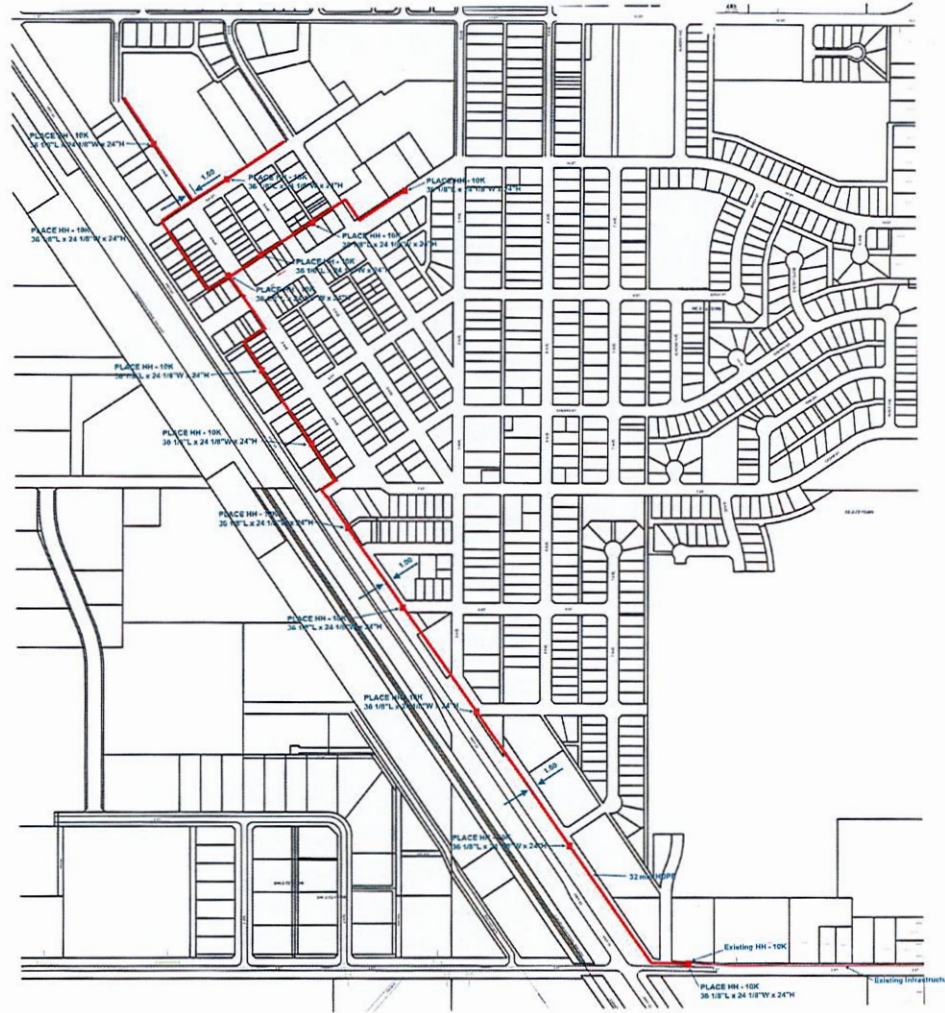

	PROPOSED CONDUIT AND CABLE		PROPOSED HANDHOLE
	PROPOSED CABLE IN EXISTING CONDUIT		EXISTING HANDHOLE
	EXISTING CONDUIT AND CABLE		CABLE SPLICE POINT

REV	YYYY/MM/DD	DESCRIPTION	BY	DESIGNED BY:	2023/02/15
				DRAWN BY:	2023/02/15
				APPROVED BY: KDJ/EBM	2023/02/15
				DWG: TOWN_OF_BVRLDGE	2023/02/15



PROJECT NUMBER: 23-001  
SCALE: N.T.S.  
VERTICAL SCALE: N/A

TITLE: GPNETWORKS  
OUTSIDE\_PLANT\_DESIGN  
LOCATION: TOWN\_OF\_BEAVERLODGE  
COUNTY\_OF\_GRANDE\_PRAIRIE\_NO1



SHEET No.

## CONSTRUCTION NOTES GPNETWORKS FIBER PLACEMENT TOWN OF BEAVER LODGE

### GENERAL NOTES

- CONTRACTOR SHALL CONTACT APPROPRIATE AUTHORITIES TO ARRANGE MARKING OF ALL EXISTING UNDERGROUND STRUCTURES AND UTILITIES IN THE LOCATION 72 HOURS IN ADVANCE OF BEGINNING ANY CONSTRUCTION ACTIVITIES. UTILITIES SHALL BE PERMANENTLY MARKED USING SUITABLE PAINT OR FLAGGING TO FACILITATE CONFLICT IDENTIFICATION PRIOR TO ALIGNMENT CONFIRMATION. LOCAL UTILITY CONSORTIUMS SHALL BE CONTACTED TO ARRANGE LOCATE INSPECTIONS AS REQUIRED. ONE CALL UTILITY IDENTIFICATION COMPANIES HAVE BEEN ESTABLISHED THROUGHOUT CANADIAN MUNICIPALITIES TO ASSIST CONTRACTORS WITH THEIR IDENTIFICATION OF UTILITIES.

- CONTRACTOR SHALL BE RESPONSIBLE FOR CONTACTING ALL RESIDENTS, BUSINESS AND MUNICIPAL DEPARTMENTS PRIOR TO CONSTRUCTION. CONTACT INFORMATION, SCHEDULE, AND IMPACT ISSUES SHOULD BE ADDRESSED IN WRITING ONE WEEK IN ADVANCE OF CONSTRUCTION START.

- CONTRACTOR ASSUMES RESPONSIBILITY FOR ANY AND ALL DAMAGES INCURRED DURING CONSTRUCTION TO PUBLIC AND PRIVATE PROPERTY. THIS INCLUDES, BUT IS NOT LIMITED TO, UNDERGROUND UTILITIES, ROAD SURFACES, ABOVE AND BELOW GROUND STRUCTURES, AND ANY OTHER PROPERTY IN THE VICINITY OF THE PROJECT. GP NETWORKS SHALL BE RELEASED FROM ANY RESPONSIBILITY FOR REPAIR OF DAMAGE TO UNDERGROUND FACILITIES INFLECTED BY THE CONTRACTOR AND/OR THEIR SUB-CONTRACTORS. THE CONTRACTOR UNDERSTANDS THE RESPONSIBILITY TO REPAIR AND REPORT ALL DAMAGE AT THE TIME OF THE INCIDENT AND AN INITIAL AND ONGOING RESPONSIBILITY TO COMPENSATE GP NETWORKS FOR FUTURE REPAIR OF ANY SUCH DAMAGE AS SET FORTH IN WARRANTY CLAUSES.

- ALL DIMENSIONS AND DESCRIPTIONS HAVE BEEN COMPILED TO THE BEST OF THE ABILITIES OF THE DESIGNER(S). ALL DIMENSIONS ARE TO BE CONFIRMED IN THE FIELD. DISCREPANCIES SHALL BE IDENTIFIED IN THE FIELD AND RECORDED ON THE AS-BUILT DRAWINGS. CONFLICTS REQUIRING REVISIONS SHALL BE IDENTIFIED BY THE CONTRACTOR 48 HOURS IN ADVANCE OF UNDERTAKING THE WORK.

- FOR ALL LA CONSTRUCTION, ONLY THE CONTRACTOR IS TO PLACE ADDITIONAL MANHOLES/HANDHOLES TO ACCOMMODATE REEL ENDS COMPLETE WITH 15 METER FIBER ENDS.

- CONTRACTOR TO PLACE TRACER WIRE PER GP NETWORKS SPECIFICATIONS IN ALL NEW BURIED LOCATIONS WHEN NONMETALLIC SHEATHED FIBER CABLE IS BEING PLACED.

- CONTRACTOR SHALL BE RESPONSIBLE FOR TRAFFIC CONTROL REQUIREMENTS, AS WELL AS VEHICULAR AND PEDESTRIAN SAFETY. THIS MAY REQUIRE COORDINATION WITH MUNICIPAL TRAFFIC CONTROL, RAILWAY AUTHORITIES, DEPARTMENT OF HIGHWAYS, FEDERAL RAILWAY AUTHORITIES, AND PRIVATE LANDOWNERS AS APPLICABLE.

- WORKING SCHEDULE SHALL BE RESEARCHED BY THE CONTRACTOR TO IDENTIFY LOCAL CONSIDERATION FOR SPECIAL EVENTS, SPORTING FUNCTIONS, PARADES, FESTIVALS, OR OTHER CONSIDERATIONS WHICH MAY IMPACT ON PROGRESS, IN ADVANCE OF FINALIZING THE SCHEDULE.

- CONSTRUCTION, MAINTENANCE AND OPERATION, SHALL BE IN ACCORDANCE WITH MUNICIPAL REGULATION, TRANSPORT CANADA, CANADIAN ELECTRICAL CODE, CSA C22.2, CSA 22.3, OSA, WCB, AND ANY OTHER ADOPTED STANDARDS REQUIRED FOR THE SAFE OPERATION AND CONSTRUCTION OF AN ELECTRICAL OR TELECOMMUNICATION SYSTEM AS APPLICABLE.

- BURIED AND MANHOLE MATERIAL AND CLEARANCE DETAILS SHOW MINIMUM VALUES ONLY. SPECIFICALLY, CLEARANCE OF 300mm VERTICAL SEPARATION AND 1000mm HORIZONTAL SEPARATION FROM INSTALLED CONDUIT TO EXISTING UTILITIES IS TO BE MAINTAINED AT ALL TIMES. MANHOLE STRUCTURES WILL BE PLACED WITH A MINIMUM 850mm CLEARANCE BETWEEN THE FINISHED ROAD SURFACE AND THE ROOF OF THE STRUCTURE.

- PLACEMENT OF DUCT PLUGS, PULL ROPE, MARKER TAPE AND SEALANT IS TO BE INCLUDED IN ALL INSTALLATIONS IN ACCORDANCE WITH THE MOST RECENT EDITION OF GP NETWORKS NETWORK STANDARDS.

- ALL WORK COMPLETED SHALL BE IN ACCORDANCE WITH MOST RECENT EDITION OF GP NETWORKS NETWORK STANDARDS.

- ALL CABLES ARE TO BE TAGGED AND IDENTIFIED AT TIME OF PLACING AND SPLICING.

### STANDARDS

- CONSTRUCTION, MAINTENANCE, OPERATION, AND GROUNDING SHALL BE IN ACCORDANCE WITH GP NETWORKS STANDARDS, MUNICIPAL, AND PROVINCIAL REGULATIONS, TRANSPORT CANADA, CANADIAN ELECTRICAL CODE, CSA C22.2, CSA C22.3, CSA C22.3 No. 1 - OVERHEAD SYSTEMS, CSA C22.3 No. 3 - ELECTRICAL COORDINATION, CSA C22.3 No. 5.1 - RECOMMENDED PRACTICES FOR ELECTRICAL PROTECTION - ELECTRIC CONTACT BETWEEN OVERHEAD SUPPLY AND COMMUNICATIONS LINES, CSA C22.3 No. 7 - UNDERGROUND SYSTEMS, OSA, WCB, AND OTHER ADOPTED STANDARDS REQUIRED FOR THE SAFE OPERATION AND CONSTRUCTION OF AN ELECTRICAL OR TELECOMMUNICATION SYSTEM AS APPLICABLE. THE MOST STRINGENT STANDARD SHALL BE ADHERED TO.

### PERMIT NOTES

- LOCATION OF ALL EXISTING UTILITIES ARE APPROXIMATE AND DO NOT REFLECT ANY RECENT CHANGES. PRIOR TO THE COMMENCEMENT OF ANY WORK, THE CONTRACTOR IS RESPONSIBLE FOR ALL LOCATES OF ALL EXISTING UTILITIES. CONTRACTOR TO CALL ALBERTA ONE CALL AT 1-800-242-3447 PRIOR TO ANY WORK.

- THE CONTRACTOR IS TO ENSURE THAT A COPY OF ALL PERMITS ARE KEPT ON SITE FOR VIEWING AT ALL TIMES.

- THESE DRAWINGS REQUIRE APPROVAL FROM VARIOUS AGENCIES PRIOR TO COMMENCEMENT OF WORK. THE CONTRACTOR IS RESPONSIBLE FOR ARRANGING A PRE-CONSTRUCTION MEETING WITH THE LEAD AGENCY PRIOR TO COMMENCING WORK.

### BENDING RADIUS

- BENDING RADIUS SHALL ADHERE TO THE FOLLOWING SPECIFICATIONS:  
 -  $\Delta=90^\circ$  R=0.09m ST=0.91m LC=1.42m E=0.38m  
 -  $\Delta=45^\circ$  R=0.90m ST=0.37m LC=0.71m E=0.07m

REV	YYYY/MM/DD	DESCRIPTION	BY	DESIGNED BY:	E.GALIZA	2021/09/13
				DRAWN BY: <td>E.GALIZA <td>2021/09/13</td> </td>	E.GALIZA <td>2021/09/13</td>	2021/09/13
				APPROVED BY: <td>KDJ/BM <td>2021/09/17</td> </td>	KDJ/BM <td>2021/09/17</td>	2021/09/17
				DWG:TOWN_OF_BVRLDGE	NOTES	



PROJECT NUMBER:	21-0025
SCALE:	1:2000
VERTICAL SCALE:	N/A



TITLE:	GPNETWORKS OUTSIDE_PLANT_DESIGN
LOCATION:	TOWN_OF_BEAVER LODGE COUNTY_OF_GRADE_PRAIRIE_NO1

SHEET No.	NOTES
-----------	-------

## TYPICAL DETAILS GPNETWORKS FIBER PLACEMENT TOWN OF BEAVERLODGE

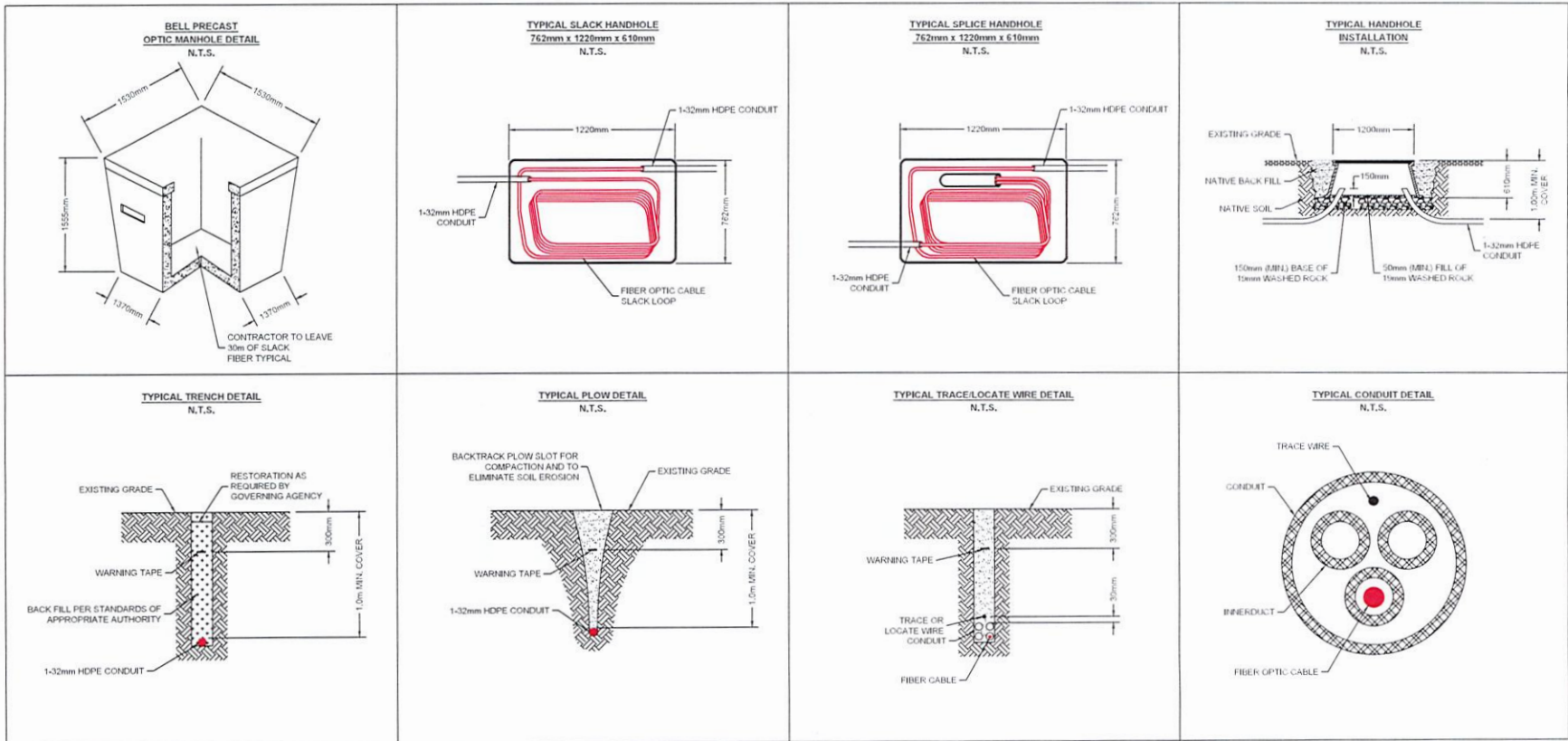

REV	YYYY/MM/DD	DESCRIPTION	BY

DESIGNED BY:	E.GALIZA	2021/09/13
DRAWN BY:	E.GALIZA	2021/09/13
APPROVED BY:	KDJ/BM	2021/09/17
DWG:	TOWN_OF_BVRLDGE	



PROJECT NUMBER:	21-0025
SCALE:	1:2000
VERTICAL SCALE:	N/A



TITLE:	GPNETWORKS OUTSIDE_PLANT_DESIGN
LOCATION:	TOWN_OF_BEAVERLODGE COUNTY_OF_GRANDE_PRAIRIE_NO1

SHEET No.	TYP01
-----------	-------

## TYPICAL DETAILS GPNETWORKS FIBER PLACEMENT TOWN OF BEAVERLIDGE

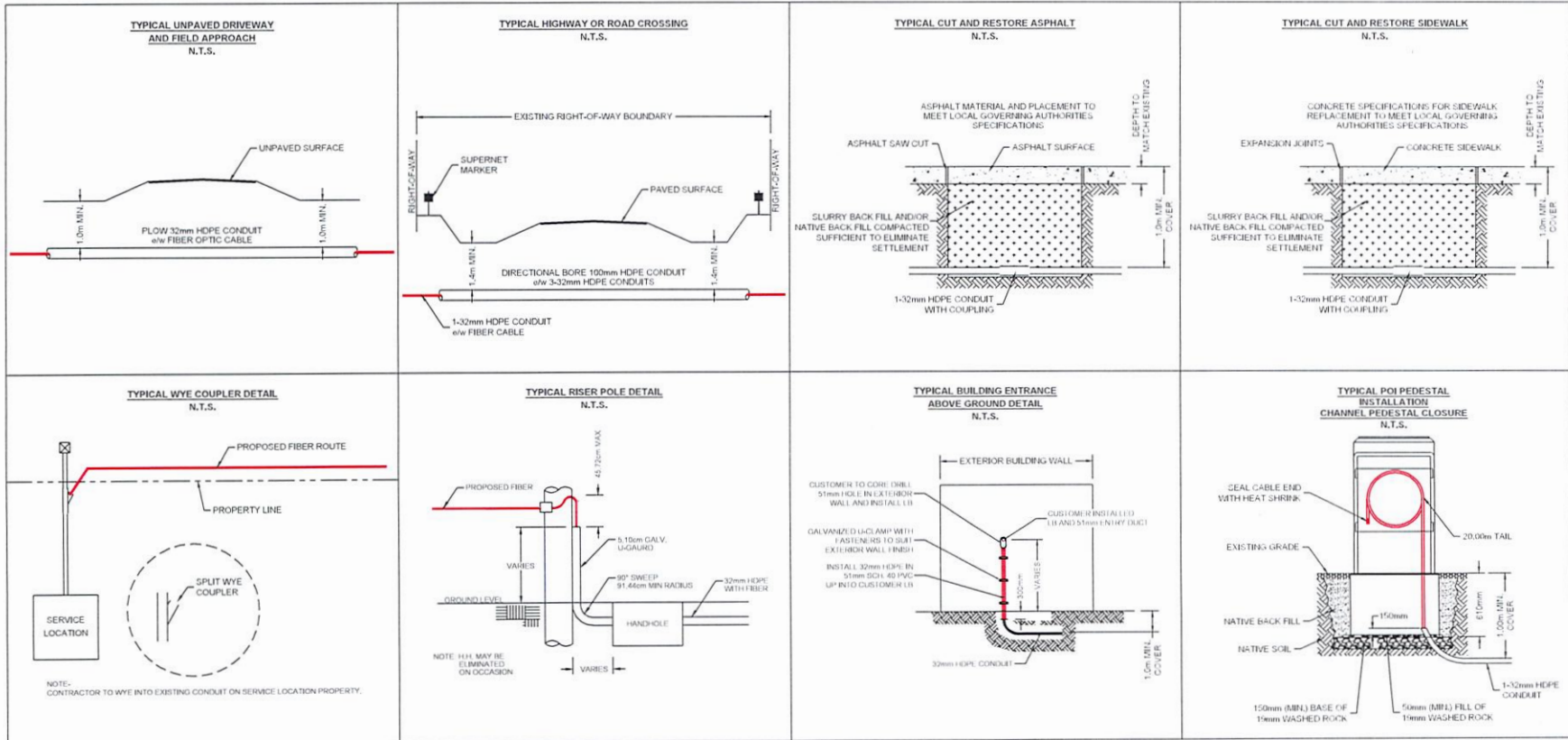

REV	YYYY/MM/DD	DESCRIPTION	BY
		DESIGNED BY: E.GALIZA	2021/09/13
		DRAWN BY: E.GALIZA	2021/09/13
		APPROVED BY: KDJ/BM	2021/09/17
		DWG: TOWN_OF_BVRLDGE	

**GPNetworks**

PROJECT NUMBER:  
21-0025  
SCALE: 1:2000  
VERTICAL SCALE: N/A



TITLE: GPNETWORKS OUTSIDE\_PLANT\_DESIGN  
LOCATION: TOWN\_OF\_BEAVERLIDGE COUNTY\_OF\_Grande\_PRAIRIE\_NO

SHEET No.  
TYP02



## LEGEND SHEET GPNETWORKS FIBER PLACEMENT TOWN OF BEAVERLODGE

EXISTING PLANT			
BOTTOM OF SLOPE	RIGHT OF WAY	MANHOLE - COMMUNICATIONS	TREE
BUSH LINE	SANITARY SEWER LINE	MANHOLE - POWER	SUPPLY - POWER
CENTER LINE	STORM SEWER LINE	MANHOLE - SANITARY SEWER	VALVE - GAS
COMMUNICATIONS LINE	TOP OF SLOPE	MANHOLE - STORM SEWER	VALVE - WATER
CROP LINE	TREE LINE	MANHOLE - WATER	VAULT - POWER
EDGE OF GRAVEL	WATER LINE	MARKER - COMMUNICATIONS	VENT - GAS
EDGE OF PAVEMENT	AMP - COMMUNICATIONS	MARKER - GAS	X-CONNECT - COMMUNICATIONS
EDGE OF WATER	ANCHOR	MARKER - POWER	
FACE OF CURB	CATCH BASIN	MARKER - SURVEY	
FENCE LINE	CAUTION SYMBOL	MARKER - WATER	
GAS LINE	CONTROL BOX - TRAFFIC	METER - GAS	
GUARDRAIL	CULVERT	METER - POWER	
PIPELINE	FENCE POST	METER - WATER	
POWER LINE	FIRE HYDRANT	PEDESTAL - COMMUNICATIONS	
PROPERTY LINE	FLAGPOLE	PEDESTAL - POWER	
RAILROAD	HANDHOLE - COMMUNICATIONS	POLE	
	HANDHOLE - POWER	PROPERTY PIN	
	HANDHOLE - TRAFFIC	RAILROAD MILE POST	
	HIGHWAY SIGN	RAILROAD SIGNAL	
	LIGHT - STREET	REPEATER - COMMUNICATIONS	
	LIGHT - TRAFFIC	SHRUB / BUSH	
		TOWER	
		TRANSFORMER - POWER	

### PROPOSED PLANT

	RUNNING LINE
	CHANGE IN CONSTRUCTION METHOD
	GUY - PLACE 10m
	GUY - PLACE 12m
	GUY - PLACE 16m
	HANDHOLE - PROPOSED
	ROD - PLACE 16mm
	ROD - PLACE 19mm
	SPLICE LOCATION
	STATION HASH MARK
	STORE SLACK

REV	YYYY/MM/DD	DESCRIPTION	BY	DESIGNED BY:	E.GALIZA	2021/09/13
				DRAWN BY:	E.GALIZA	2021/09/13
				APPROVED BY:	KDJ/BM	2021/09/17
				DWG: TOWN_BVRLDGE_	LEGEND	

**GPNetworks**

PROJECT NUMBER:	21-0025
SCALE:	1:2000
VERTICAL SCALE:	N/A

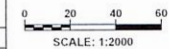

TITLE:	GPNETWORKS OUTSIDE_PLANT_DESIGN
LOCATION:	TOWN_OF_BEAVERLODGE COUNTY_OF_GRANDE_PRAIRIE_NO1

SHEET No.	LEGEND
-----------	--------