

**AGENDA FOR THE TOWN OF BEAVERLODGE COUNCIL MEETING  
MONDAY JANUARY 8, 2024 AT 7:00 PM**

**IN COUNCIL CHAMBERS #400-10 STREET BEAVERLODGE, AB**

*Microsoft Teams meeting Join on your computer, mobile app or room device*  
[Click here to join the meeting](#) Meeting ID: 239 718 810 409 Passcode: 4YSZRM

<b>1.0</b>	<b><u>CALL TO ORDER:</u></b>  <i>Town of Beaverlodge's Legislative Meetings are being live streamed effective June 12, 2023 via Council resolution #145-2023-05-23</i>	
<b>2.0</b>	<b><u>LAND ACKNOWLEDGEMENT:</u></b>	PP 2
<b>3.0</b>	<b><u>ADOPTION OF AGENDA:</u></b>	
<b>4.0</b>	<b><u>ADOPTION OF MINUTES:</u></b>  4.1 December 11, 2023 - Regular Council Meeting Minutes	PP 3-5
<b>5.0</b>	<b><u>DELEGATIONS:</u></b>  5.1 Government Frameworks – Phillip Hicks & Amy Underwood	PP 6
<b>6.0</b>	<b><u>OLD BUSINESS:</u></b>	
<b>7.0</b>	<b><u>NEW BUSINESS:</u></b>  7.1 Snow Removal Policy PW-01-01 – <i>from C.O.W. Dec 11, 2023</i>  7.2 Appointment of Auditors for 2023	PP 7-20  PP 21
<b>8.0</b>	<b><u>CORRESPONDENCE:</u></b>  8.1 Minutes from the December 11, 2023 Committee of the Whole Meeting  8.2 Alberta Transportation & Economic Corridors – Response to Rural Bus Lines  8.3 Wildfire Prevention Committee – Town of Hinton  8.4 Beaverlodge Mural Foundation – Thank You Letter	PP 22,23  PP 24,25  PP 26,27  PP 28
<b>9.0</b>	<b><u>COMMITTEE AND STAFF REPORTS:</u></b>  9.1 Action List  9.2 Council Reports	PP 29
<b>10.0</b>	<b><u>CLOSED SESSION:</u></b>	
<b>11.0</b>	<b><u>ADJOURNMENT:</u></b>	



Box 30, Beaverlodge, AB T0H 0C0

**Phone: 780.354.2201**

**Fax: 780.354.2207**

As long as the sun shines, grass grows and the rivers flow – we acknowledge the homeland of the many diverse First Nation & Métis people whose ancestors have walked this land.

We are grateful to live, learn and work on the traditional territory of Treaty 8 and we make this acknowledgement as an act of reconciliation and gratitude.



**REGULAR COUNCIL MEETING MINUTES**  
**MONDAY DECEMBER 11, 2023 AT 7:00 PM**

**COUNCIL CHAMBERS 400-10 ST, BEAVERLODGE, ALBERTA**

<b>COUNCIL</b>	Mayor Gary Rycroft Councillor Hugh Graw Councillor Cyndi Corbett Councillor Ryier Hommy	Deputy Mayor Judy Kokotilo-Bekkerus Councillor Cal Mosher Councillor Cody Moulds
<b>STAFF</b>	Jeff Johnston, CAO	Tina Letendre, Deputy CAO Nichole Young, Legislative Services

**1.0 CALL TO ORDER** Mayor Gary Rycroft called the meeting to order. **7:00 PM**

**2.0 LAND ACKNOWLEDGEMENT**

*As long as the sun shines, grass grows and the rivers flow – we acknowledge the homeland of the many diverse First Nation and Métis people whose ancestors have walked this land. We are grateful to live, learn and work on the traditional territory of Treaty 8 and we make this acknowledgement as an act of reconciliation and gratitude.*

**3.0 ADOPTION OF AGENDA**

**#289-2023-12-11** Councillor Cyndi Corbett

**CARRIED:** That Council adopts the agenda with the following change:

- Addition of Closed Session Item 10.1 Legal – Grande Spirit Foundation – FOIP Section 25

**4.0 ADOPTION OF MINUTES**

3.1 November 27, 2023 – Regular Council Meeting Minutes

**#290-2023-12-11** Councillor Ryier Hommy

**CARRIED:** That Council adopts the minutes of the November 27, 2023 Regular Council Meeting as presented.

**5.0 DELEGATIONS:**

5.1 South Peace Regional Archives – Ellyn Vandekerkhove & Janice Shields

**#291-2023-12-11** Councillor Cyndi Corbett

**CARRIED:** That Council accepts this presentation for information.

**6.0 OLD BUSINESS:**

**7.0 NEW BUSINESS:**

7.1 2023 Interim Budget

**#292-2023-12-11** Councillor Ryier Hommy

**CARRIED:** That Council approve the 2024 Interim Operating Budget based on 50% of the Approved 2023 Operating Budget as detailed in Appendix 1.

*\*Councillor Ryier Hommy excused himself from the room, citing a conflict with New Business Item 7.2.* **7:23PM**

7.2 Facility & Fee Waiver – Beaverlodge Daycare – Annual Gala

**#293-2023-12-11** Deputy Mayor Judy Kokotilo-Bekkerus

**CARRIED:** That Council approves a 50% fee reduction for the annual Beaverlodge Daycare Gala.

*\*Councillor Ryier Hommy returned to the meeting.* **7:25PM**

7.3 Facility & Fee Waiver – Beaverlodge & District Chamber of Commerce Christmas Luncheon

**#294-2023-12-11** Councillor Cyndi Corbett

**CARRIED:** That Council approves a 50% fee reduction for the Chamber Christmas Luncheon.

7.4 Facility & Fee Waiver – Beaverlodge Barracudas – Regular Season

**#295-2023-12-11** Mayor Gary Rycroft

**CARRIED:** That Council approves a 1-year rate of \$75/hr, a 50% discount on the regular rate of \$150/hr for Barracuda’s regular season practice hours for 2024.

7.5 Facility & Fee Waiver – Beaverlodge Barracudas – Annual Swim Meet

**#296-2023-12-11** Councillor Cyndi Corbett

**CARRIED:** That Council approves a 50% fee reduction for the Barracuda’s annual swim meet.

**8.0 CORRESPONDENCE:**

8.1 Committee of the Whole Meeting Minutes – November 27, 2023

**#297-2023-12-11** Councillor Cyndi Corbett

**CARRIED:** That Council adopts the minutes from the November 27, 2023 Committee of a Whole meeting as presented.

8.2 Peace Library System – Board Meeting Highlights Nov 25, 2023

**#298-2023-12-11** Councillor Cyndi Corbett

**CARRIED:** That Council accepts this report for information.

**9.0 COMMITTEE AND STAFF REPORTS**

9.1 Action List

**#299-2023-12-11** Councillor Ryier Hommy

**CARRIED:** That Council accepts the Action Item List as presented.

9.2 Council & Staff Reports

**#300-2023-12-11** Councillor Hugh Graw

**CARRIED:** That Council accepts these Council and Staff Activity Reports for information as presented.

**10.0** **CLOSED SESSION**

**#301-2023-12-11** Deputy Mayor Judy Kokotilo-Bekkerus **7:43 PM**

**CARRIED:** That Council moves into Closed Session for Item 10.1 Legal – Grande Spirit Foundation – FOIP Section 25.

**#302-2023-12-11** Councillor Hugh Graw **7:56 PM**

**CARRIED:** That Council moves out of Closed Session.

**#303-2023-12-11** Councillor Ryier Hommy

**CARRIED:** That Council accepts the Closed Session item for information.

**11.0** **ADJOURNMENT** Mayor Gary Rycroft adjourned the meeting. **7:56 PM**

---

Mayor Gary Rycroft

---

CAO Jeff Johnston



Share

Download



Box 30, 400 - 10th Street  
Beaverlodge, AB T0H 0C0

DELEGATIONS TO COUNCIL

Name of Delegates(s): Philip Hicks  
Amy Underwood

Representing: GovernmentFrameworks.com

Phone Number: +1 (877) 870 0150

Email: Amy@gfwcorp.com, Philip@gfwcorp.com

Topic: Forms, Automation, Records Management, & Executive Reporting

Staff Familiar with topic: Yes

Attached Information: PowerPoint Slide Deck

Notes: Limit presentation to 15 minutes

Delegate Signature: *Amy Underwood*

Date: 2023-12-06

All notifications and documentations must be sent to  
If you have materials/documentation to be included in the Agenda, they must be received by 1:00pm the  
Tuesday before the meeting you are scheduled to appear before Council.

Any documentation submitted (including this Delegate Application)  
is considered "Public Information" and will appear in a Council Agenda.

FOR OFFICE USE ONLY

Date and Time of Council Meeting to attend: Jan 8 / 24

Approved to Present by: T.L. Date: Dec 6 / 23

Town of Beaverlodge's Legislative Meetings are being live streamed effective June 12, 2023  
via Council resolution #145-2023-05-23

**Email**  
town@beaverlodge.ca

**Phone**  
780-354-2201

**Website**  
beaverlodge.ca



Policy Title:	Snow Removal Policy	Policy #: PW-01-01
Authority Approval:	MAYOR & COUNCIL	Resolution #:
		Effective Date: 2023-12-05
Distribution:	<input checked="" type="checkbox"/> Master <input checked="" type="checkbox"/> Administration <input checked="" type="checkbox"/> Council <input type="checkbox"/> FCSS	<input type="checkbox"/> Fire Department <input type="checkbox"/> Library <input checked="" type="checkbox"/> Public Works <input type="checkbox"/> Recreation

**Purpose:** To establish the levels of service and set priorities in regards to removing of snow from the Town's streets and sidewalks.

**Policy Statement:**

The Town of Beaverlodge desires to ensure that public roadways within the corporate limits of the Town of Beaverlodge are maintained in a condition that:

1. Maximizes public safety; and
2. Allows response to emergencies by Fire, Ambulance and Police Services; and
3. Allows access to the Town of Beaverlodge Hospital; and
4. Allows access to the schools; and
5. Allows access to essential utility services; and
6. Permits reasonable vehicular access to primary highways, businesses, industry, schools, residences recreational facilities, and public services.

Therefore, the Town of Beaverlodge will undertake roadway snow plowing and snow removal operations on a priority basis.

The policy must remain flexible and serves as a guideline for snow plowing and removal operations. Operational and administrative decisions that affect snow plowing and priorities are made by the CAO or designate.

**Definitions:**

**1. As Required**

A statement which means that the level of service is not set at a pre-determined number of activity occurrences per season or year. It allows operating forces to apply field judgement and expertise to varying weather conditions.

**2. Boulevard**

The area between a roadway curb and a separate sidewalk or between a roadway curb and property line where there is no sidewalk.

**3. Cul-de-sac**

A dead-end road with a hub at the dead end to allow for vehicle 180 degree turning movements.

**4. Drifting**

Depositing of wind-blown snow on roadways or lanes which make the passage of vehicle difficult or impossible.

**5. Monolithic Sidewalk**

A sidewalk which is integral with the curb and gutter structure.

**6. Rutting**

The formation of troughs or ridges in excess of 5 centimeters in depth in compacted snow or ice.

**7. Sanding**

The application of sand-chips-salt-calcium or other mixture to a roadway surface for the purpose of improving traction, reduction of skidding and/under or reduction of ice formation. Emphasis is placed on intersections, corners, hills, school zones, playground zones and other known problem areas.

**8. Snow Pack**

The buildup thickness of packed snow on roadway surfaces.

**9. Snow Plowing**

The grading of accumulated snow from roadway surfaces to the sides or middle of a roadway.

**10. Snow Removal**

The loading and hauling of snow from roadway surfaces to a designated snow disposal site.

**11. Temporary No Parking Signage**

Temporary signage in the form of Sandwich boards, or posted signage, indicating a 24 hour parking ban for snow maintenance.

**12. Windrowing**

The temporary storage and accumulation of plowed snow onto boulevards, the middle of the roadway, and ditches.



**Guidelines:**

The Town of Beaverlodge will undertake roadway, sanding, snowplowing, and snow removal operations in the following order of priority. There may be extreme snowfall events which exceed the capacity of available manpower and equipment to carry out the work listed within the time allotted; however, in that case the order of priority will not change.

1. Hospital, Fire, Ambulance, Access routes
2. Central Business District, and Schools
3. Arterial and Collector Roads
4. Local Residential Roadways
5. Industrial

1. Hospital, Fire, Ambulance access routes

These are noted on attached map "Schedule A"

Snow is plowed and stored to side or middle of the roadway after each snowfall as determined by Public Works Manager or designate. The Town will remove windrows once there is potential to cause safety or drainage problems as determined by the Public Works Manager or designate.

- 1.1 Sanding operations will be undertaken in the same manner and frequency as Arterial and Collector Roads.
- 1.2 The Town will endeavor to keep Fire Hydrants clear of snow at all times. Property owners are strongly encouraged to clear snow from fire hydrants on or around their property to ensure the Town can quickly gain access in the event of a fire.
- 1.3 Parking ban signage is in effect to allow for snow removal. Vehicles parked in the restricted area will be towed as per Bylaw 1010 Traffic Bylaw.

2. Central Business District, Schools

These are noted on attached map "Schedule B"

Snow is plowed and stored to side or middle of the roadway after each snowfall as determined by Public Works Manager or designate. The Town will remove windrows once there is potential to cause safety or drainage problems as determined by the Public Works Manager or designate.

- 2.1 Sanding operations will be undertaken in the same manner and frequency as Arterial and Collector Roads.
- 2.2 The Town will endeavor to keep Fire Hydrants clear of snow at all times. Property owners are strongly encouraged to clear snow from fire hydrants on or around their property to ensure the Town can quickly gain access in the event of a fire.
- 2.3 Parking ban signage is in effect to allow for snow removal. Vehicles parked in the restricted area will be towed as per Bylaw 1010 Traffic Bylaw.

### 3. Arterial and Collector Roads

These are noted on attached map "Schedule C"

Snow is plowed and stored to side or middle of the roadway after each snowfall as determined by Public Works Manager or designate. The Town will remove windrows once they reach a height where there is potential to cause safety or drainage problems as determined by the Public Works Manager or designate.

- 3.1 Snow plowing operations will generally utilize road right-of-way for snow storage as follows:
  - 3.1.1 On roads that have boulevards and/or median, snow may be plowed onto the boulevard and/or median.
  - 3.1.2 On Roads that have monolithic curb and sidewalk on 1 side only, snow may be plowed onto the opposite side or to the middle.
  - 3.1.3 On roads that have monolithic curb and sidewalk on both sides, snow may be plowed to the side that does not have a driving lane directly adjacent to the curb. Or where there is parking on both sides of the street, snow may be plowed to the middle or to the side that has fewer driveways facing the roadway.
  - 3.1.4 Snow will not be placed on municipal sidewalks.
  - 3.1.5 Plowing operations may continue on an ongoing basis after initial road plowings in order to address rutting and drifting.

- 3.1.6 Snow windrows up to 12.5 cm (5") average height of the length of the driveway of un-compacted snow may be left in front of driveways and laneway entrances. Where windrows exceed 12.5 cm in height, the Town will endeavor to open up windrows to either side as soon as reasonably possible.
- 3.1.7 Where a snow windrow is placed across designated handicap parking or any type of pedestrian crosswalk, the Town will endeavor to open up the windrow to either side within eight hours of the windrow being placed.
- 3.1.8 Where a snow windrow is placed around a parked vehicle, the town will endeavor to remove the windrow after the vehicle has been removed.
- 3.1.9 Snow windrows placed in front of private sidewalks will not be removed.
- 3.1.10 Snow clearing and sanding operations of Town of Beaverlodge arena and pool facilities parking lots will generally commence following completion of arterial and collector roadways.

#### 4. Local Residential Roadways and Laneways

These are noted on attached map "Schedule D"

- 4.1 A "snow pack" condition will be maintained on these roadways and laneways. Once the snow pack has reached a compacted average depth that hinders drivers it will either be:
  - 4.1.1. Plowed, where there is sufficient room on boulevards, medians or park areas to store snow. Plowing will be undertaken in the same manner as Arterial, and Collector Roadways. In cul-de-sac with central park areas, the snow would be plowed onto the park areas. In cul-de-sac areas without central park areas, the snow would be plowed into the centre of the cul-de-sac and removed at the earliest opportunity.
  - 4.1.2. Removed, where there is not sufficient room within the carriageway to store snow. Removal will be undertaken in the same manner as Arterial and Collector Roadways.
- 4.2 Removal and plowing operations would be completed on a neighbourhood-by-neighbourhood basis. This would rotate after each snowfall so that different neighbourhoods would be completed first.

4.3 If a significant snow fall should occur during operations in a local residential neighbourhood, the remainder of the local residential neighbourhood will be completed after the Arterial and Collector and Downtown Business Districts are completed.

Areas prone to drifting snow or with steep gradients may be plowed or sanded more frequently.

4.4 Snow windrows up to 12.5 cm (5") average height of the length of the driveway of un-compacted snow may be left in front of driveways. Where windrows exceed 12.5 cm in height, the Town will endeavor to open up windrows to either side within a reasonable time period.

## 5. Industrial

These are noted on attached map "Schedule E"

5.1 A "snow pack" condition will be maintained on these roadways and laneways. Once the snow pack has reached a compacted average depth that hinders drivers it will be plowed.

## 6. Temporary No Parking Signage

6.1 Anywhere within the Town of Beaverlodge other than specified routes is subject to temporary 24-hour parking ban signage in order to allow for snow plowing/removal/windrowing as required. Vehicles parked in the restricted area will be towed as per Bylaw 1010 Traffic Bylaw.

### 6.2 Sanding operations will be undertaken as follows:

6.2.1. Generally, sanding will occur between the hours of 6:00 a.m. and 5:00 p.m. in effort to have the roads sanded before the bulk of the commuter traffic leaves in the morning and returns in the evening.

6.2.2 Sanding between the hours of 5:00 p.m. and 10:00 p.m. would be completed as determined by the Public Works Manager or designate.

6.2.3. Sanding between the hours of 10:00 p.m. and 6:00 a.m. would be completed by call out only, as determined by the Public Works Manager or designate.

6.2.4 Sanding routes and priorities follow Arterial, Collector and Downtown Business District Roadways.

6.2.5 Sanding operations conducted on a seven day per week basis, as determined by the Public Works Manager or designate.



Box 30, Beaverlodge, AB T0H 0C0

Phone: 780.354.2201

Fax: 780.354.2207

### Sidewalks

The Town of Beaverlodge will undertake, sanding, snowplowing, and snow removal operations for the sidewalks identified in red in the attached "Schedule F" within 24 hours of the end of a snowfall of 10 centimeters or more. There may be extreme snowfall events which exceed the capacity of available manpower and equipment to carry out the work listed within the time allotted; however, in that case the list of priority will not change.

The Town of Beaverlodge will not be responsible for snow clearing or sanding of sidewalks adjacent to businesses, privately-owned homes, or non-Town owned facilities.

### Snow Disposal Site

The Town has two locations for snow disposal as noted on attached map "Schedule G" The first site, marked "1", is located at Highway Ave and is for the use of Town operations only. The second location, marked "2", can be used by businesses and residents and Sports grounds. Access to these locations will be maintained by the Public Works Department, and will have the same priority as the residential plowing.

Date: \_\_\_\_\_

\_\_\_\_\_  
Mayor Gary Rycroft

\_\_\_\_\_  
CAO Jeff Johnston



County of  
Grande Prairie No. 1  
Alberta, Canada

# Town of Beaverlodge

Town of Beaverlodge

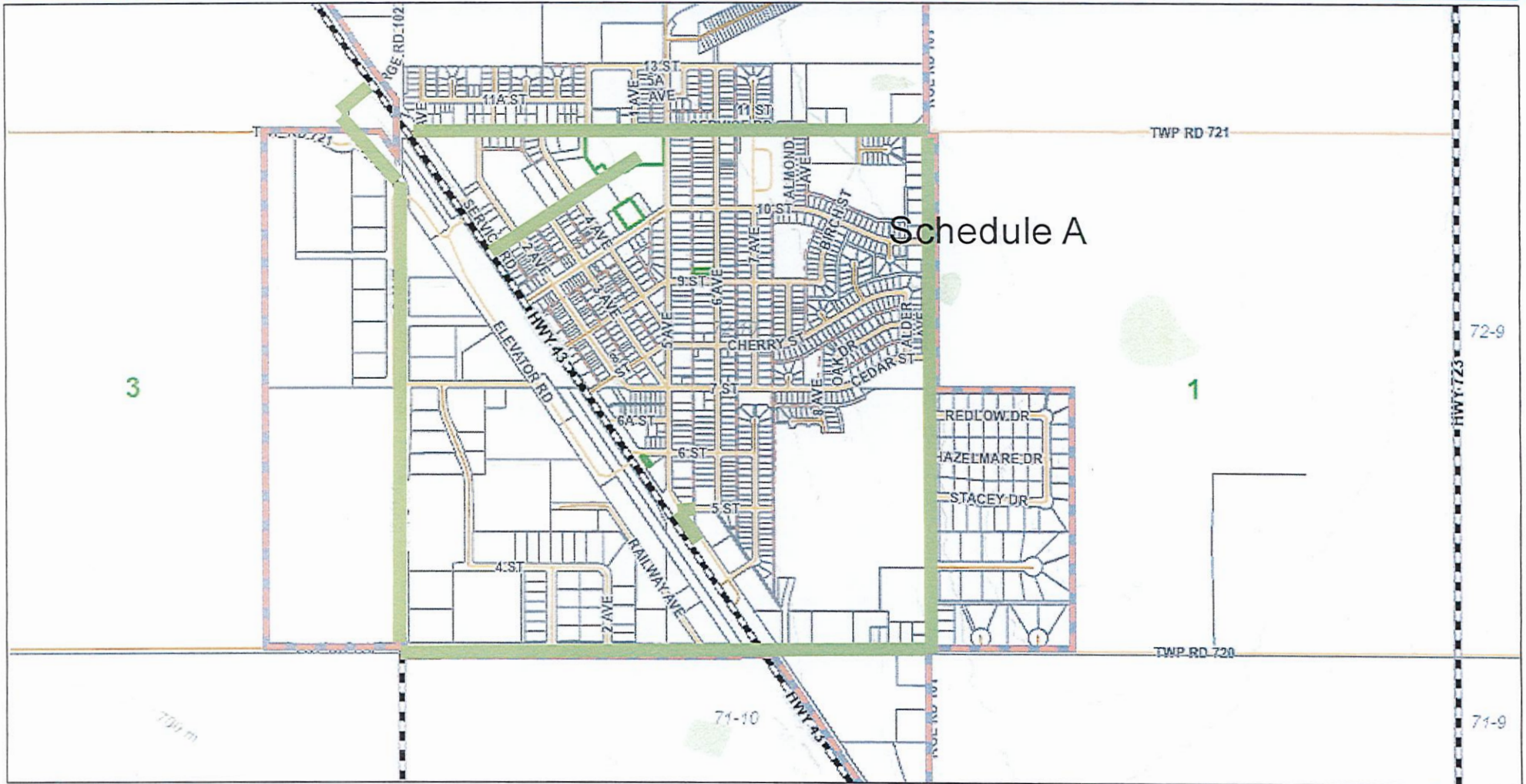

Scale 1:30,070

Legend

**Municipal Boundaries**

City / County

Village / Town

Township and Range Grid

Quarter Labels  
Road Labels

Provincial Highways

**Major Roads**

Highway

Arterial

Collector

Unnamed Access Road

Turnaround

Ramp

Service Rd

N

The County of Grande Prairie No. 1 makes no representation or warranties regarding the information contained in this document, including, without limitation, whether the said information is accurate or complete. Persons using this document do so solely at their own risk, and the County of Grande Prairie No. 1 shall have no liability to such persons for any loss or damage whatsoever. Names may appear different than how they are registered with Alberta Land Titles. This document may not be copied or distributed to any other person without the express written consent of the County of Grande Prairie No. 1

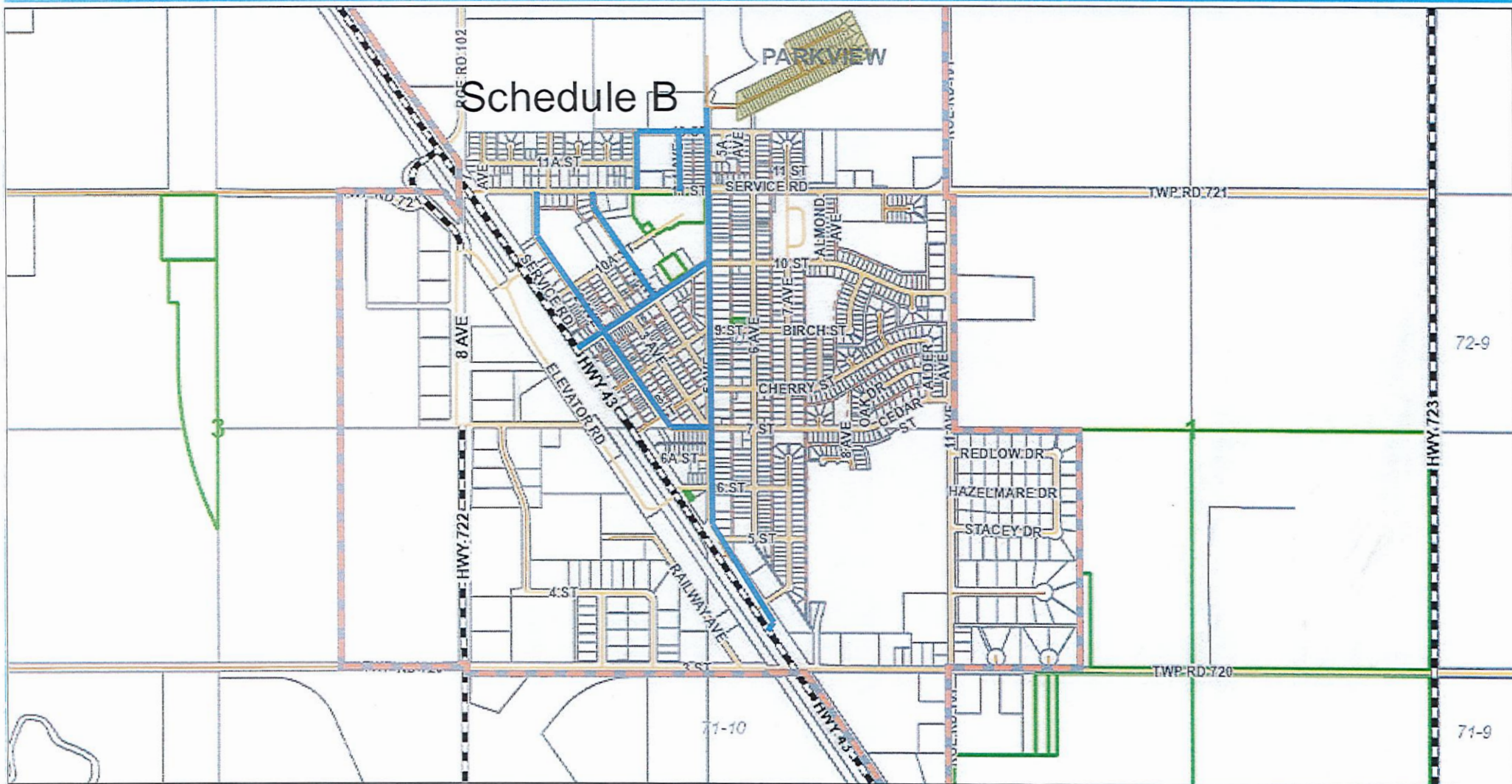

Scale 1:32,638

Legend

Municipal  
Boundaries

City / County

Village / Town

Neighbourhoods /  
Subdivisions

Manufactured  
Home  
Community

Road Labels

Provincial  
Highways



The County of Grande Prairie No. 1 makes no representation or warranties regarding the information contained in this document, including, without limitation, whether the said information is accurate or complete. Persons using this document do so solely at their own risk, and the County of Grande Prairie No. 1 shall have no liability to such persons for any loss or damage whatsoever. Names may appear different than how they are registered with Alberta Land Titles. This document may not be copied or distributed to any other person without the express written consent of the County of Grande Prairie No. 1



County of  
Grande Prairie No. 1  
Alberta, Canada

# County of Grande Prairie No. 1

County of Grande Prairie No. 1

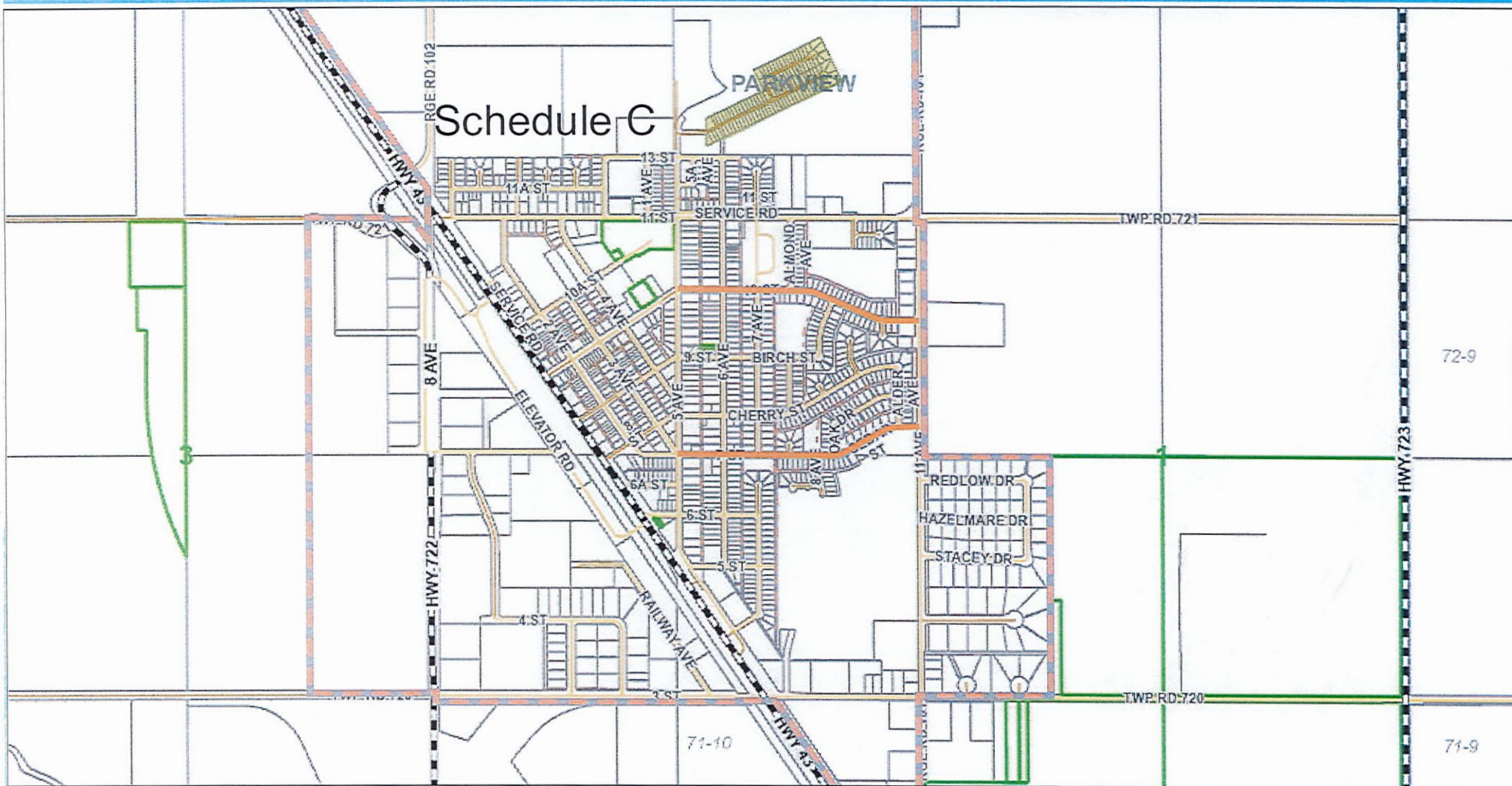

Scale 1:32,804

Legend

**Municipal  
Boundaries**

City / County

Village / Town

**Neighbourhoods /  
Subdivisions**

Manufactured  
Home  
Community

Road Labels

Provincial  
Highways



The County of Grande Prairie No. 1 makes no representation or warranties regarding the information contained in this document, including, without limitation, whether the said information is accurate or complete. Persons using this document do so solely at their own risk, and the County of Grande Prairie No. 1 shall have no liability to such persons for any loss or damage whatsoever. Names may appear different than how they are registered with Alberta Land Titles. This document may not be copied or distributed to any other person without the express written consent of the County of Grande Prairie No. 1





County of  
Grande Prairie No. 1  
Alberta, Canada

# County of Grande Prairie No. 1

County of Grande Prairie No. 1

## Schedule D

PARKVIEW

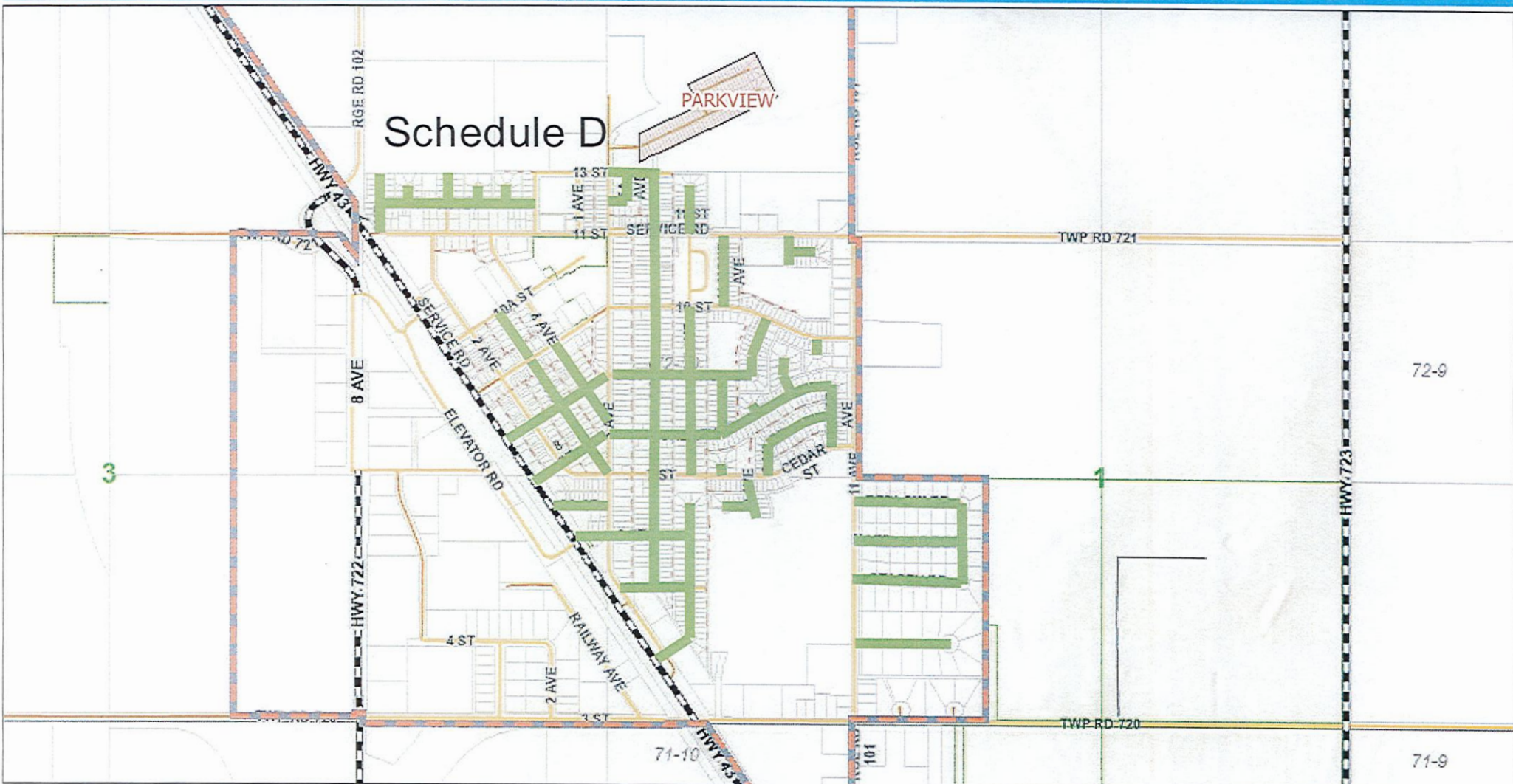

Scale 1:32,363

Legend

Municipal  
Boundaries

City / County

Village / Town

Subdivisions  
and Named  
Areas

Parcel Fabric  
- Outline

Crown

Parcels

Road Labels

Provincial  
Highways



The County of Grande Prairie No. 1 makes no representation or warranties regarding the information contained in this document, including, without limitation, whether the said information is accurate or complete. Persons using this document do so solely at their own risk, and the County of Grande Prairie No. 1 shall have no liability to such persons for any loss or damage whatsoever. Names may appear different than how they are registered with Alberta Land Titles. This document may not be copied or distributed to any other person without the express written consent of the County of Grande Prairie No. 1



County of  
Grande Prairie No. 1  
Alberta, Canada

# County of Grande Prairie No. 1

County of Grande Prairie No. 1

## Schedule E

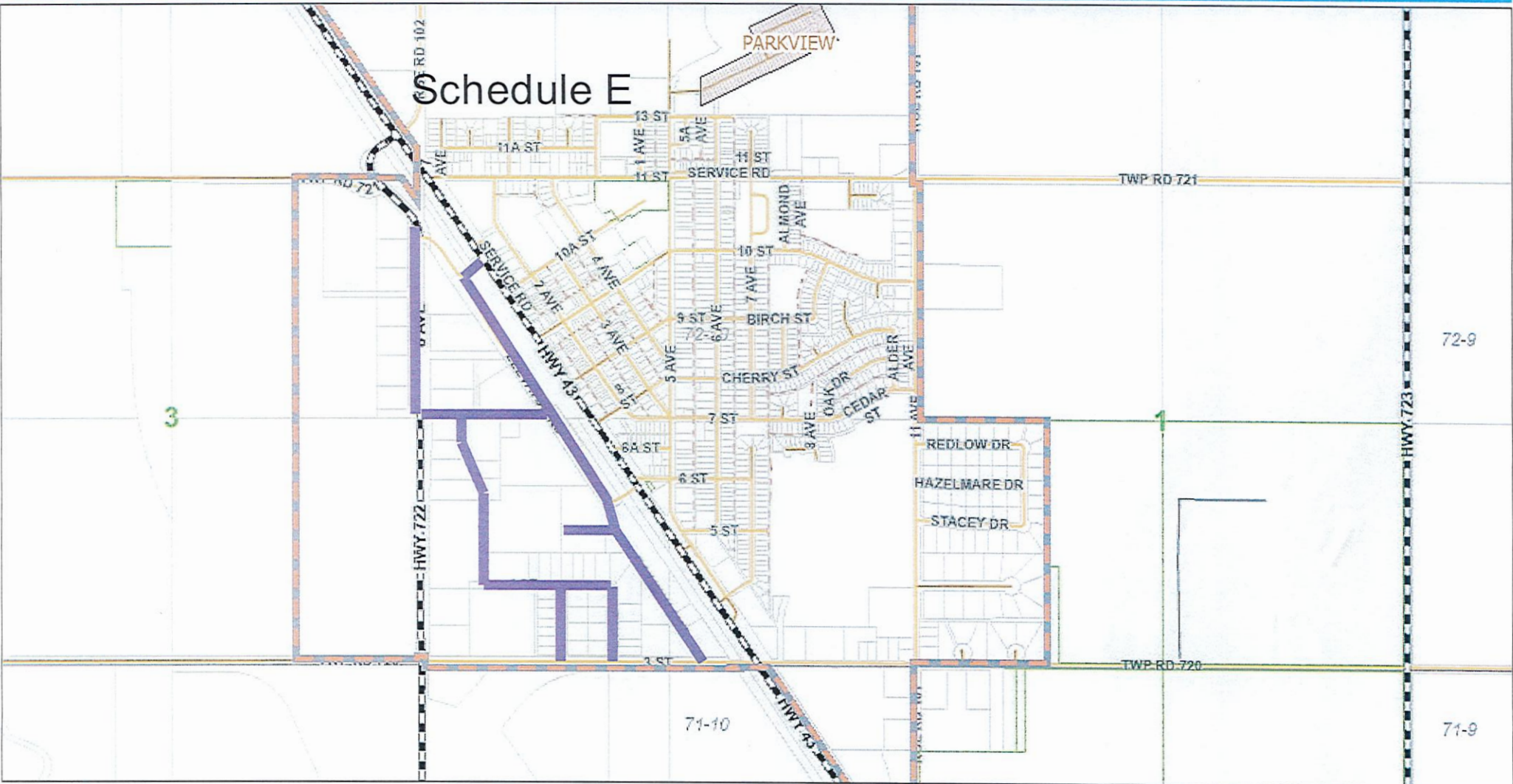

Scale 1:32,363

Legend

Municipal  
Boundaries

City / County

Village / Town

Subdivisions  
and Named  
Areas

Parcel Fabric  
- Outline

Crown

Parcels

Road Labels

Provincial  
Highways



The County of Grande Prairie No. 1 makes no representation or warranties regarding the information contained in this document, including, without limitation, whether the said information is accurate or complete. Persons using this document do so solely at their own risk, and the County of Grande Prairie No. 1 shall have no liability to such persons for any loss or damage whatsoever. Names may appear different than how they are registered with Alberta Land Titles. This document may not be copied or distributed to any other person without the express written consent of the County of Grande Prairie No. 1



# Town of Beaverlodge

Town of Beaverlodge

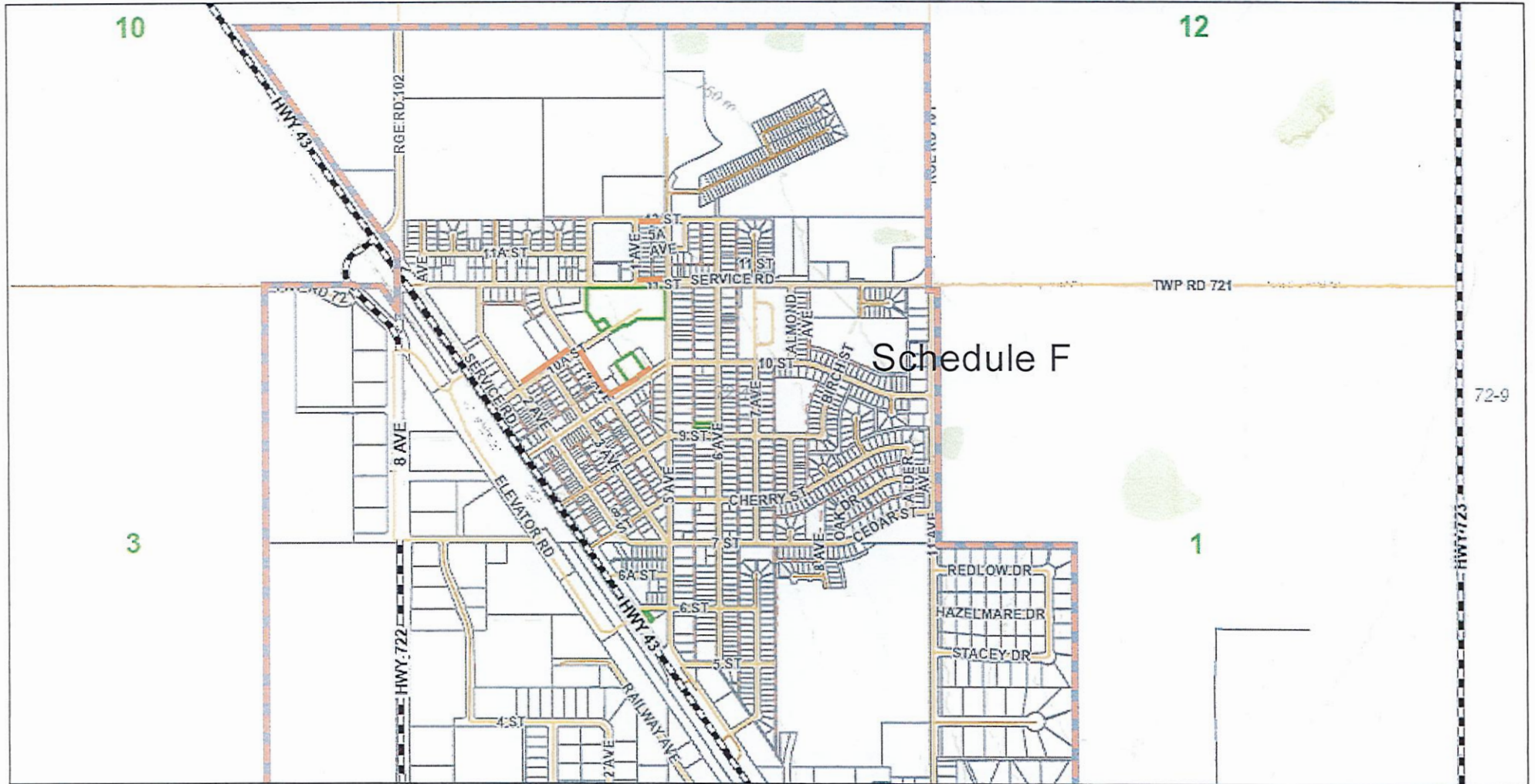

Scale 1:30,223

Legend

**Municipal Boundaries**

City / County

Village / Town

Township and Range Grid

Quarter Labels

Road Labels

Provincial Highways

**Major Roads**

Highway

Arterial

Collector

Unnamed Access Road

Turnaround

Ramp

Service Rd



The County of Grande Prairie No. 1 makes no representation or warranties regarding the information contained in this document, including, without limitation, whether the said information is accurate or complete. Persons using this document do so solely at their own risk, and the County of Grande Prairie No. 1 shall have no liability to such persons for any loss or damage whatsoever. Names may appear different than how they are registered with Alberta Land Titles. This document may not be copied or distributed to any other person without the express written consent of the County of Grande Prairie No. 1.



County of  
Grande Prairie No. 1  
Alberta, Canada

# Town of Beaverlodge

Town of Beaverlodge

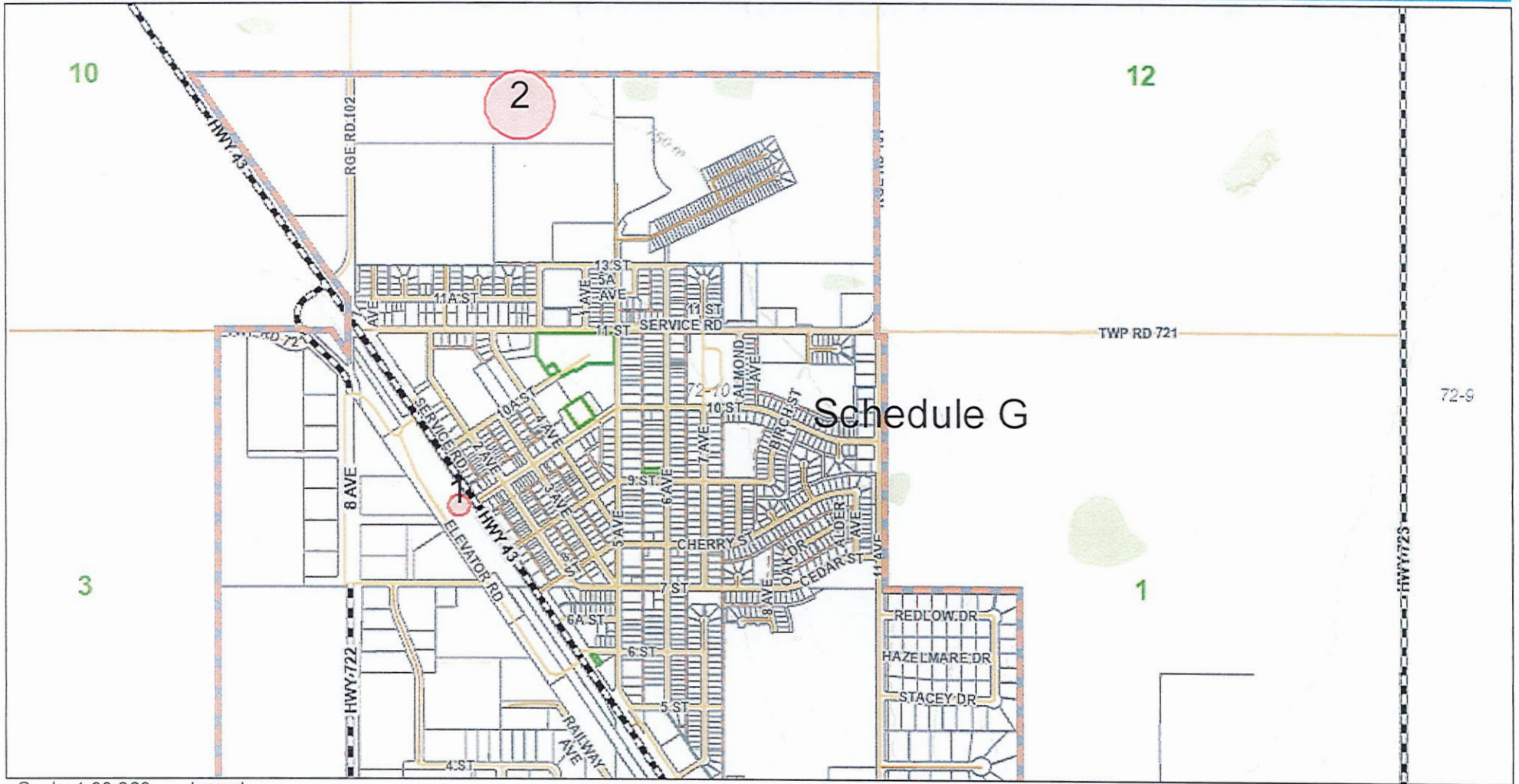

Schedule G

Scale 1:30,223

Legend

Municipal  
Boundaries

City / County

Village / Town

Township and  
Range Grid

Quarter Labels

Road Labels

Provincial  
Highways

Major Roads

Highway

Arterial

Collector

Unnamed  
Access Road

Turnaround

Ramp

Service Rd

N



The County of Grande Prairie No. 1 makes no representation or warranties regarding the information contained in this document, including, without limitation, whether the said information is accurate or complete. Persons using this document do so solely at their own risk, and the County of Grande Prairie No. 1 shall have no liability to such persons for any loss or damage whatsoever. Names may appear different than how they are registered with Alberta Land Titles. This document may not be copied or distributed to any other person without the express written consent of the County of Grande Prairie No. 1

Council must appoint one or more auditors for the Town.

Council Motion:

*That Council appoints MNP LLP to be the Auditors for the Town of Beaverlodge for 2023.*



**COMMITTEE OF THE WHOLE MEETING MINUTES**

**COUNCIL CHAMBERS 400 10 St, BEAVERLODGE DECEMBER 11, 2023 @ 6:00 PM**

**COUNCIL** Mayor Gary Rycroft Deputy Mayor Judy Kokotilo-Bekkerus  
Councillor Cal Mosher Councillor Hugh Graw  
Councillor Cody Moulds Councillor Cyndi Corbett  
Councillor Ryier Hommy

**STAFF** Jeff Johnston, CAO Tina Letendre, Deputy CAO  
Nichole Young, Legislative Services

**1.0** **CALL TO ORDER:** Mayor Gary Rycroft called meeting to order. **6:00 PM**

**2.0** **LAND ACKNOWLEDGMENT:**

*As long as the sun shines, grass grows and the rivers flow – we acknowledge the homeland of the many diverse First Nation & Métis people whose ancestors have walked this land. We are grateful to live, learn and work on the traditional territory of Treaty 8 and we make this acknowledgement as an act of reconciliation and gratitude.*

**3.0** **ADOPTION OF AGENDA:**

**#182-2023-12-11** Councillor Ryier Hommy

**CARRIED:** That the Committee of the Whole adopts the agenda as presented.

**4.0** **DELEGATION:**

**5.0** **OLD BUSINESS:**

**6.0** **NEW BUSINESS:**

6.1 Snow Removal Policy

**#183-2023-12-11** Councillor Hugh Graw

**CARRIED:** That the Committee of the Whole recommends the Snow Removal Policy be brought to Council on January 8, 2024 for approval.

6.2 Beaverlodge FCSS – Passionate Hearts Invitation – Feb 14, 2024

**#184-2023-12-11** Councillor Cal Mosher

**CARRIED:** That the Committee of the Whole recommends this item be tabled for the January 8, 2024 Committee of the Whole Meeting.

6.3 McNaught Homestead Donation Request

**#185-2023-12-11** Councillor Ryier Hommy

**CARRIED:** That the Committee of the Whole accepts this for information.

6.4 Town Newsletter – Council Contribution

**#186-2023-12-11** Mayor Gary Rycroft

**CARRIED:** That the Committee of the Whole requests that Administration explore and investigate options to fully maximize the content of the Newsletter.

6.5 Mountview Health Complex Committee Update - Announcement

**#187-2023-12-11** Councillor Ryier Hommy

**CARRIED:** That the Committee of the Whole accepts this for information.

6.6 Community Enhancement Committee Update

**#179-2023-11-27** Councillor Cody Moulds

**CARRIED:** That the Committee of the Whole accepts this for information.

6.7 Economic Development Committee Update

- *no update at this time.*

**7.0** **TOPICS FOR NEXT AGENDA:**

- Mountview Health Complex Committee Update
- Community Enhancement Committee Update
- Economic Development Committee Update

**8.0** **ADJOURNMENT:** Mayor Gary Rycroft adjourned the meeting.

**6:39 PM**

---

Mayor Gary Rycroft

---

CAO Jeff Johnston



ALBERTA

TRANSPORTATION AND ECONOMIC CORRIDORS

*Office of the Minister  
MLA, Innisfail-Sylvan Lake*

December 4, 2023

AR 95123

His Worship Gary Rycroft  
Mayor  
Town of Beaverlodge  
Box 30, 400 - 10 Street  
Beaverlodge, AB T0H 0C0

Dear Mayor Rycroft:

Thank you for your letter regarding the challenges that rural bus support lines encounter in providing bus services to rural Albertans. As Minister of Transportation and Economic Corridors, I am able to provide the following information.

I applaud your dedication to assist rural Albertans in meeting their transportation needs and improve access to education, health services, and employment opportunities. Transportation and Economic Corridors launched the Rural Transit Pilot Program in 2018, following Greyhound's departure from Alberta, to improve transportation connections in rural areas where no existing services were provided. A review of the Rural Transportation Pilot Program is underway and is expected to be completed later this year. This evaluation will help us in determining next steps for rural transportation. In addition, the province has been advocating for support from the federal government for intercity bus operators. This industry is important in connecting rural and remote communities in Alberta. Since 2022, the province has been urging the federal government to consider providing greater support for this industry by expanding eligibility under the Rural Transit Solutions Fund.

The federal government has undertaken formal engagement with the provinces on the Canadian Public Transit Fund through way of engagement papers and questionnaires. The federal government provided a high-level overview of the funding approaches being considered, current status, and anticipated next steps at a meeting in the summer and will be providing further details at a meeting scheduled for the fall. There was also confirmation that \$3 billion annually has been approved by the federal cabinet, and the program parameters are in draft form. Over the next few months, the federal government will work closely with transit partners to refine program design and strengthen our collective ability to deliver high-quality and accessible public transit and active transportation for Canadians.

**RECEIVED**  
**DEC 21 2023**

.../2

127 Legislature Building, 10800 - 97 Avenue NW, Edmonton, Alberta T5K 2B6 Canada Telephone 780-427-2080 Fax 780-422-2002

*Printed on recycled paper*

Classification: Protected A

8.2



In addition, the federal government launched the \$250 million Rural Transit Solutions Fund to target the development of transit solutions in rural and remote communities in 2021. This federal funding is provided over five years to support the development of locally driven transit solutions that will help people living in rural communities get to work, school, and appointments, and to visit loved ones. Funding will help rural, remote, Northern, and Indigenous communities to develop and offer new public transit options to their residents, including on demand services, publicly owned ride shares, and volunteer community carpooling. Unfortunately, this funding restricts eligibility to capital investments and planning studies and therefore excludes operating costs and the private intercity bus industry.

Please be assured that my department intends to continue working with rural municipalities to hear concerns and consider practical options to support public transportation for rural residents.

Thank you for taking the time to write.

Sincerely,

A handwritten signature in cursive script, appearing to read "Devin Dreeshen".

Honourable Devin Dreeshen, ECA  
Minister of Transportation and Economic Corridors

cc: Ron Wiebe, MLA for Grande Prairie-Wapiti



## TOWN OF HINTON

December 4, 2023

**RECEIVED**  
DEC 08 2023

The Honourable Todd Loewen  
Minister of Forestry and Parks  
Members of Executive Council  
Executive Branch  
323 Legislature Building  
10800-97 Avenue  
Edmonton, AB T5K 2B6  
[fp.minister@gov.ab.ca](mailto:fp.minister@gov.ab.ca)

Dear Minister Loewen,

I am writing on behalf of the Town of Hinton Mayor and Council. We commend the efforts and dedication of the Mountain Pine Beetle Control Committee in mitigating the impact of the beetle infestation in our forests. However, the rapid and severe escalation of wildfire risks demands an immediate shift in focus and strategy.

The increasing frequency and intensity of wildfires in our region present a clear and present danger to our communities, natural resources, and our way of life. We assert that transitioning from the Mountain Pine Beetle Control Committee to a Wildfire Prevention Committee is not just a prudent choice but an imperative one. We believe that by prioritizing fire prevention, we address the root cause of both the immediate and long-term threats to our beloved province.

The devastating consequences of wildfires cannot be overstated. Lives are at stake, as are the livelihoods of countless individuals and families who call this region home. The economic, ecological, and emotional toll of such disasters is immeasurable. The pine beetle infestation, though significant, pales in comparison to the potential devastation wrought by uncontrolled wildfires.

Considering recent data provided by the province showing the extent of wildfire impact across Alberta, it has become evident that communities like Fort McMurray, Edson, High Level, Banff, and Peace River, among others, are significantly affected. These communities, which fall within the top clusters of wildfire-affected areas, underscore the urgent need for a unified and collaborative approach to wildfire management and prevention.

Collaboration between high-risk communities is crucial. By sharing experiences, knowledge, and strategies, we can collectively enhance our preparedness and response to wildfires. Communities that have previously faced such disasters bring invaluable insights that can aid in developing more effective prevention and mitigation strategies. Learning from each other and supporting one another not only strengthens each community's ability to handle wildfires but also fosters a sense of solidarity and resilience across the province.

We firmly believe that the transition to a Wildfire Prevention Committee not only aligns with the broader objectives of the Alberta government but is a committed step towards safeguarding our communities and preserving the very essence of our province.

Furthermore, we implore you, as the Alberta Forest Ministry, to ensure that affected communities have a meaningful seat at the table in discussions and decisions pertaining to wildfire prevention and management. The collective expertise and experience of our communities should be valued as we work together to secure the future of Alberta's forests and the well-being of its residents.

We urgently request an opportunity to discuss this proposal further with you and your esteemed team. Your leadership in championing this crucial shift in focus would have a profound and lasting impact on the safety and prosperity of our region.

Thank you for your immediate attention to this matter. We look forward to your support in safeguarding the heart of our province.

Sincerely,



Nicholas Nissen  
Mayor

cc. Fort McMurray  
Fort Chipewyan  
Edson  
Whitecourt  
High Level  
Rainbow Lake  
Banff  
Canmore  
Peace River  
Manning  
Grande Prairie  
Beaverlodge  
Slave Lake  
Athabasca  
High Prairie  
Pincher Creek  
Crowsnest Pass  
Yellowhead County  
Parkland County  
Lac LeBish  
Grande Cache  
Greenview County



# Beaverlodge Mural Foundation

The Beaverlodge Mural Foundation  
would like to thank the following sponsors  
for their generous support for our 2023 murals

BPOE Elks

Town of Beaverlodge

Northgate Electric

County of Grande Prairie

Parks and Recreation

Beaverlodge Home

Building Centre

Prairie Signs

Philip J. Currie

Dinosaur Museum

McNaught Homestead

Preservation Society

ACE Hardware

Beaverlodge Art Club

Beaverlodge Regional

High School Art Club

Beaverlodge

Dental Centre

Petals on Main

Town & Country News

Astrid Noga

Pat Wearmouth

Catherine Nychka

Don Albright

Sam Kitt

Michelle Forrester

Roger Harcourt

Helen Teichroeb

Suzanne Sandboe

Brent and Susan Calvert

Item Number	Subject	Requested On	People Responsible	Item Notes	Status	Target Date of Completion
1	10A St & Highway 43 (Subway Intersection)	22-Jun-20	CAO/Admin	Intersection has been surveyed - 2023 capital plan. Only \$50K in current budget, rest will be deferred to 2023 due to higher than expected pricing.	ON HOLD	8/1/2023
2	Recreation Centre Rate Review	27-Sep-21	CAO/Admin	CAO has received the rates and will review and bring to next Council meeting.	In progress	9/30/2023
3	Grande Prairie & District Catholic School Board	26-Oct-20	CAO/Admin	Sent Draft Joint Use Partnership Agreement to GPDCSD	In progress	9/30/2023
4	Community Bus Policy	8-May-23	Admin	Review and update this policy and it's fees and charges.	In Progress	12/31/2023
5	Main Street Sign	23-Oct-23	Admin	Proceed with updating the Main Street Sign - adding reflective paint on letters and arrow	In progress	
6	Amend Bylaw #1003	14-Nov-23	Admin	Amend Bylaw #1003 - Fire Department Bylaw to reflect the signing of the Fire Services Agreement with the County of Grande Prairie	In progress	
7	Dog Waste Signs	14-Nov-23	Admin	Obtain and post signs	Completed	
8	Manhole Power	14-Nov-23	Admin	Investigate what running power to the manhole in the center of 10th St and 2nd Ave would look like	In progress	
9	Town Newsletter	11-Dec-23	Admin	Explore options to schedule and plan Council's contribution.		

Current: Monday, January 8, 2024